

Barter Pattern

If you like this pattern, send a fat quarter to Annette Truong PO Box 111104, Campbell CA 95011-1104

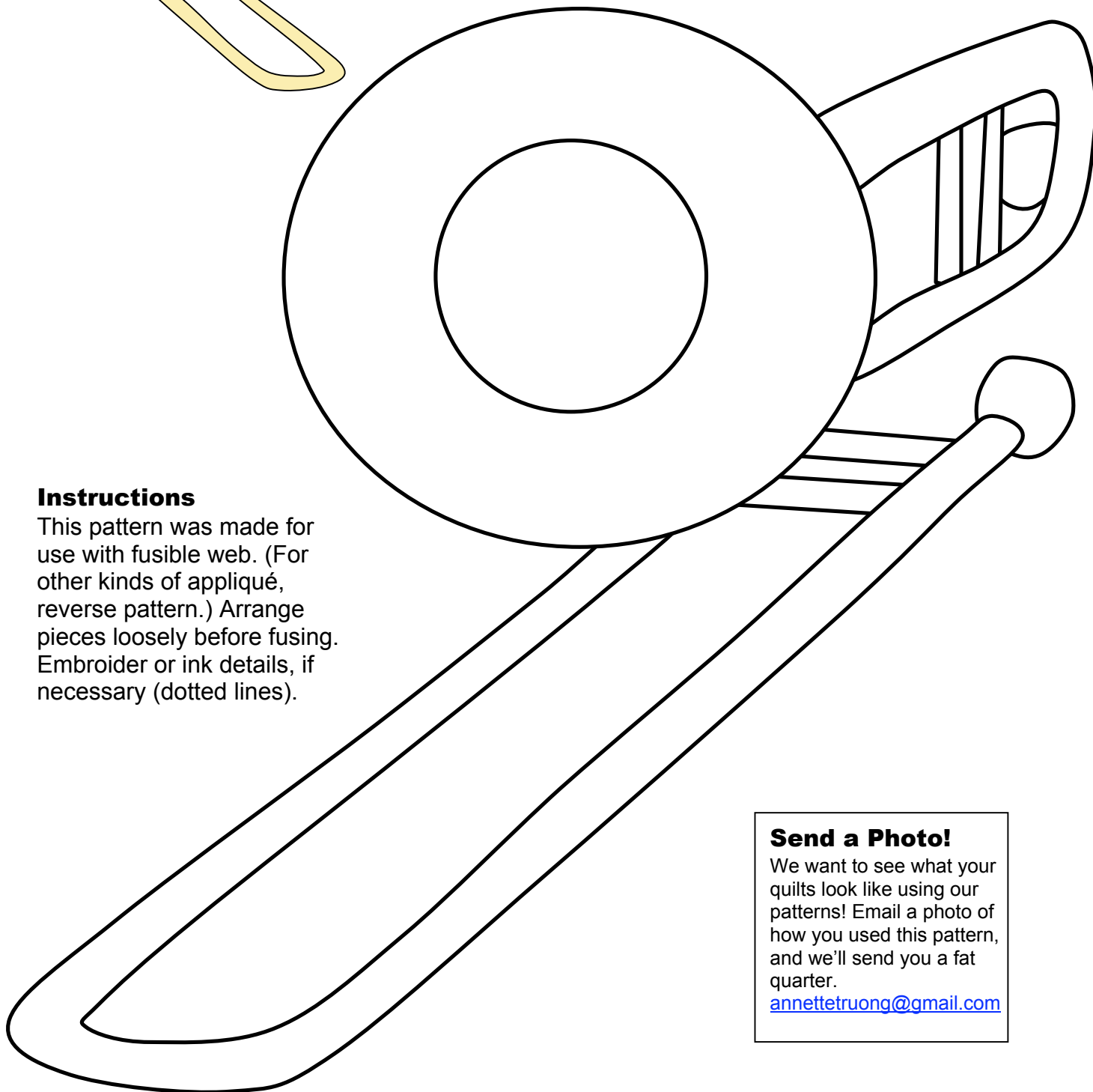

Instructions

This pattern was made for use with fusible web. (For other kinds of appliqué, reverse pattern.) Arrange pieces loosely before fusing. Embroider or ink details, if necessary (dotted lines).

Send a Photo!

We want to see what your quilts look like using our patterns! Email a photo of how you used this pattern, and we'll send you a fat quarter.

annettetruong@gmail.com